



Canadian Society of Breast Imaging
Soci t  canadienne de l'imagerie mammaire

2019 Canadian Society of Breast Imaging Conference

PROGRAM

May 18-19, 2019



INDUSTRY SPONSORS

The Canadian Society of Breast Imaging gratefully acknowledges the participation of the following corporate sponsors, each of whom has provided an unrestricted educational grant in support of the CSBI 2019 Conference program. Together, we are working to build a strong breast imaging community in Canada.

Thank you to our sponsors!



Canadian Association of Radiologists
L'Association canadienne des radiologistes



THE CANADIAN SOCIETY OF BREAST IMAGING

ABOUT

The idea of forming a group dedicated to breast imaging in Canada has been going on for some time. Professionals interested in breast imaging have been engaged in the European Society of Breast Imaging as well as the Society of Breast Imaging in the United States. Recognizing that there was a need for a place to discuss uniquely Canadian issues related to breast imaging, the CSBI was founded in October 2017 with the support of the CAR. Founding members include senior leading breast imagers from across the country including: Drs. Jean Seely (ON), Nancy Wadden (NL), Shiela Appavoo (AB), Anabel Scaranelo (ON), Yves Loisel (QC) and Paula Gordon (BC).

The CSBI is a home for Canadian breast imaging professionals and patients to discuss best practices, pressures on the system and to celebrate successes. The CSBI will also be a focused vehicle to bring breast imaging stories from Canada to the rest of the world and vice versa.

PURPOSE

- To establish a society for the improvement and dissemination of breast imaging
- To promote high quality breast imaging that is patient centered
- To improve the quality of medical education in the practice of breast imaging
- To foster research in all aspects of breast imaging
- To provide a medium for the exchange of ideas among clinicians, researchers and healthcare professionals involved with breast imaging
- To provide meetings for presentation and discussion of papers and the dissemination of knowledge in the area of breast imaging
- To establish a channel for publication of scientific reports in the field of breast imaging; and
- To respond to public / media inquiries concerning breast imaging.

2019 CONFERENCE PLANNING COMMITTEE

Jean Seely (Chair, ON)
Shiela Appavoo (AB)
Mona El-Khoury (QC)
Anat Kornecki (ON)
Supriya Kulkarni (ON)
Yves Loisel (QC)
Colin Mar (BC)
Declan Rowan (ON)
Anabel Scaranelo (ON)
Stephanie Schofield (NS)
Nancy Wadden (NL)
Huiming Yang (AB)



GENERAL INFORMATION

CSBI Conference Venue and Host Hotel

Hôtel Château Laurier
1220 Place George V O, Québec, QC G1R 5B8

Registration and Information Desk

Saturday, May 18, 2019

Foyer Grand Allée Est from 10:00-12:00

Sunday, May 19, 2019

Foyer Des Plaines from 07:00-09:00

Badges

CSBI Conference name badges must be worn and visible at all times by all delegates. They are required to access all scientific sessions. Name badges are not transferable. Please do not alter, deface and avoid covering name badges with business cards, pins or stickers.



FLOOR MAPS

PLAN DU REZ-DE-CHAUSSÉE / GROUND FLOOR PLAN

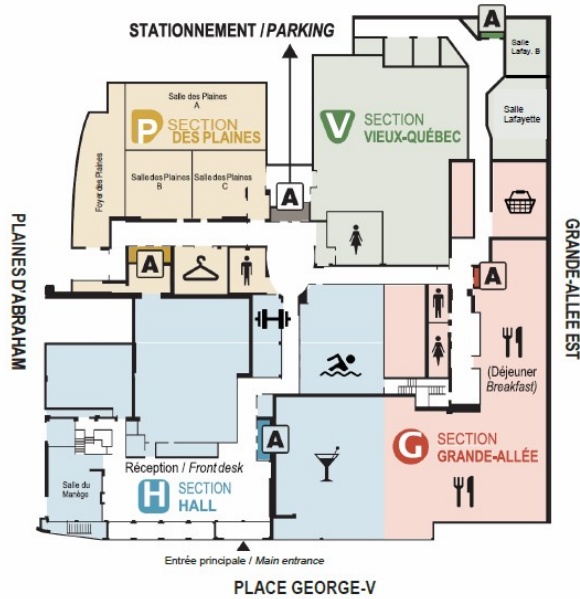

PLAN NIVEAU 1 / 1ST FLOOR PLAN

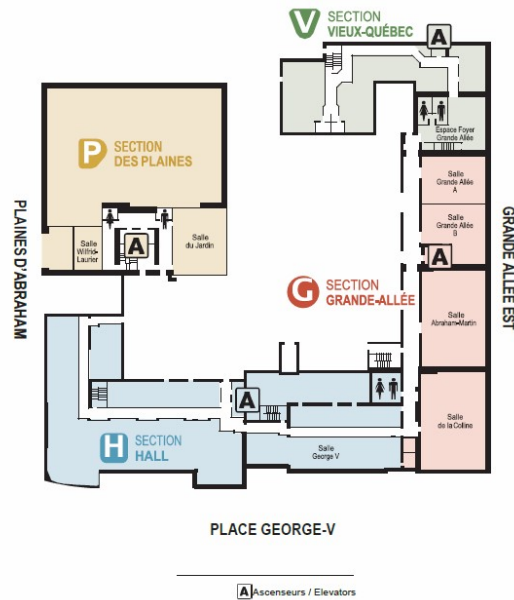



PROGRAMME INFORMATION

Needs Assessment

The 2019 CSBI conference is intended to bring together practitioners from a variety of health fields to educate and collaborate on current breast imaging practices in Canada. The lectures and workshops will explore how radiologists and other imaging professionals can work to save life years and improve the quality of life through the early detection of breast cancer, make use of cutting-edge technologies to improve imaging quality, and better engage patients in the continuum of breast imaging care.

Target Audience

This conference is designed for general and subspecialty radiologists involved in breast imaging. It is also appropriate for health practitioners from other disciplines (family medicine, medical radiation technologists, physicists), and patients who are interested in working collaboratively to improve breast imaging care.

Overall Learning Objectives

At the end of the conference, participants should be able to:

1. Analyze newer technologies in breast imaging including digital breast tomosynthesis, breast ultrasound, contrast enhanced mammography and breast MRI as supplements to mammography for diagnosis and screening of breast cancer.
2. Discuss and analyse the current scientific debate about personalized and supplemental screening of women with dense breast tissue.
3. Describe the current scientific debate about use of screening mammography in Canada, and current recommendations.

ACCREDITATION

The Second Annual CSBI Conference is an Accredited Group Learning Activity (Section 1) with an Accredited Self-Assessment Program (Section 3) and an Accredited Simulation Activity (Section 3) as defined by the Maintenance of Certification Program of the Royal College of Physicians and Surgeons of Canada (RCPSC) and approved by the Canadian Association of Radiologists. The program is approved for a maximum of 5 hours (Section 1).

- Participants in the Breast Ultrasound Workshop are eligible to claim a maximum of **1.5 hours** (credits are automatically calculated) under Section 3 (Self-Assessment Program) of the Royal College MOC program.
- Participants in the Tomosynthesis Workshop are eligible to claim a maximum of **8 hours** (credits are automatically calculated) under Section 3 (Simulation Based Activity) of the Royal College MOC program.

Accreditation for American Radiologists

Through an agreement between the Royal College of Physicians of Surgeons of Canada and the American Medical Association (AMA), physicians may convert Royal College MOC credits to *AMA PRA Category 1 Credits*[™].



Information on the process to convert Royal College MOC credits to AMA credits can be found at www.ama-assn.org/go/internationalcme.

Accreditation for Technologists

The Second Annual CSBI Conference is accredited through the CAMRT Continuing Education Credit Approval Program (CECAP) and is also recognized for continuing education credit by the American Society of Radiologic Technologists (ASRT) as well as the American Registry of Radiologic Technologists (ARRT). A total of **5.25 Category A credits** are available for participants who attend the entire 2 day conference.

*IMPORTANT: Technologists intending to claim Category A credits **must** sign in and sign out of each session that they attend. Tracking sheets will be made available at the beginning and end of each session. Credits will not be awarded or included on certificates of attendance unless attendance at each session is tracked and validated accordingly.*

CERTIFICATE OF ATTENDANCE

A certificate of attendance will be available for all delegates after the conference. An email will be sent to you within a month following the conference.

Participants can document their learning in the RCPSC MAINPORT at <https://login.royalcollege.ca/oamlogin/login.jsp>

PRESENTATIONS

Unless otherwise indicated under individual sessions, each presentation is scheduled for 30 minutes. Speakers are allotted 25 minutes to present and 5 minutes to answer questions from the audience. Every session has been designed as an educational offering to advance practitioners' professional development and the profession.

DISCLAIMER

No responsibility is assumed by the CSBI for any injury and/or damage to persons or property as a matter of product liability, negligence or otherwise, or from any use or operations of any methods, products, instructions or ideas contained in materials distributed or described during presentations throughout the CSBI 2019 Conference. Because of rapid advances in the medical sciences, in particular, independent verification of diagnoses and drug dosages should be made. Although all advertising material on location and in print is expected to conform to ethical (medical) standards, inclusion in this event does not constitute a guarantee or endorsement of the quality or value of such product or of the claims made of it by its manufacturer and representatives.

CBSI EVALUATION FORMS

Your comments and feedback are instrumental in helping us plan future meetings and events.

We encourage all participants to fill out the overall conference evaluation available online at <https://www.surveymonkey.com/r/CSBI2019>

Session evaluation forms will be sent to participants via email throughout the conference and will also be made available online at the end of the conference.



Disclosure of Conflict of Interest

The CSBI has a formal policy regarding the need for authors and presenters to inform CSBI attendees of any Conflict of Interest (COI). A COI includes, but is not limited to, employment, ownership of stock, membership on a standing advisory council or committee, or being on the board of directors or publicly associated with a company or its products. Other potential areas of real or perceived conflict of interest could include receiving honoraria, consulting fees, or grants.

ANNUAL GENERAL MEETING

The inaugural general meeting of the CSBI will be held over the lunch hour in Des Plaines A. We ask that all members attend the Canadian Society of Breast Imaging Meeting.

DATE: Sunday May 19

TIME: 12h00-12h30

LOCATION: Des Plaines A

ELECTRONIC ACCESS

This programme is available electronically at <https://csbi.ca/conference/>



AGENDA

Saturday May 18, 2019

10:00 – 12:00	Registration	Foyer Grand Allée Est
07:00 – 13:00	Exhibitors	Espace Foyer des Plaines
12:00 – 13:00	Lunch	Des Plaines BC
13:00 – 17:00	Tomosynthesis Workshop (Part A) <i>Yves Loisel</i> *Radiologists Only, Requires Pre-Registration*	De la Colline
17:00 – 18:00	CSBI Opening Reception	Espace Foyer des Plaines

Sunday May 19, 2019

07:00 – 09:00	Registration	Foyer Grand Allée Est
07:00 – 08:00	Breakfast	Des Plaine BC
08:00 – 13:00	Exhibitors	Espace Foyer des Plaines
08:00 – 08:15	Opening Remarks/Welcome <i>Jean Seely</i>	Des Plaines A
08:15 – 09:00	Personalized and Supplemental Screening <i>Wendie Berg</i>	Des Plaines A
09:00 – 09:30	Screening Protocols and Paradigms in France <i>Catherine Colin</i>	Des Plaines A
09:30 – 10:00	Population Breast Cancer Screening in Canada <i>Gregory Doyle</i>	Des Plaines A
10:00 – 10:15	Break	Espace Foyer des Plaines
10:15 – 10:45	Is It Really a Small Cyst? <i>Wendie Berg</i>	Des Plaines A
10:45 – 11:15	Contrast-Enhanced Mammography <i>Anat Kornecki</i>	Des Plaines A
11:15 – 11:45	Paradigms of Breast Imaging in Canada from the Inauguration of CSBI to now <i>Jean Seely</i>	Des Plaines A
11:45 – 1:00	Lunch (Dessert served in Foyer Des Plaines) *CSBI Annual General Meeting (all invited) – 12:00-12:30	Des Plaines A
13:00 – 17:00	Tomosynthesis Workshop (Part B) <i>Yves Loisel</i> *Radiologists Only, Requires Pre-Registration*	De la Colline



13:30 – 15:00	Breast Ultrasound Workshop <i>Supriya Kulkarni</i>	Abraham-Martin
15:00 – 15:30	Break	Espace Foyer des Plaines
15:30 – 16:30	Dense Breast Plenary Panel <i>Moderator: Jean Seely</i> Panelists: Shiela Appavoo, Sharlene Bilmer, Catherine Colin, Paula Gordon, Colin Mar	Des Plaines A

OPENING REMARKS & WELCOME

Jean Seely, MDCM, FRCPC

08:00 – 08:15

Des Plaines A

KEYNOTE SESSION

PERSONALIZED AND SUPPLEMENTAL SCREENING

Wendie A. Berg, MD, PhD, FACR, FSBI

08:15 – 09:00

Des Plaines A

This presentation is a 30-minute lecture, followed by an interactive 10-minute question and answer session.

PRESENTATION SUMMARY: This session will identify women who do not benefit as much as others from routine mammographic screening and discuss data supporting methods to improve outcomes in such women.

LEARNING OBJECTIVES

At the end of the presentation, participants will be able to:

1. Discuss limitations of standard mammography screening: high-risk populations and dense breasts
2. Describe results with supplemental MRI screening
3. Detail outcomes from screening ultrasound after tomosynthesis

SCIENTIFIC AND EDUCATIONAL SESSIONS

Screening Protocols and Paradigms in France

Catherine Colin, MD, PhD

09:00 – 09:30

Des Plaines A

PRESENTATION SUMMARY:



LEARNING OBJECTIVES

At the end of the presentation, participants will be able to:

1. Discuss French national breast screening guidelines
2. Describe how breast density contributes to the ongoing discussion about the necessity of supplemental screening using ultrasound.

Population Breast Cancer Screening in Canada

Greg Doyle

09:30 – 10:00

Des Plaines A

PRESENTATION SUMMARY:

This presentation will give a brief history of the origins and development of organized, population-based breast cancer screening programs in Canada. It will explain how screening programs have evolved overtime and how the body of knowledge of cancer screening and mammography have expanded, while reviewing the role of quality determinants and evaluation indicators in the delivery of breast cancer screening. The presentation will also explore the potential impact of the PERSPECTIVE project as it pertains to personalized screening.

LEARNING OBJECTIVES:

At the end of the presentation, participants will be able to:

1. Discuss why and how we do population-based breast cancer screening in Canada and the limitations of breast cancer screening
2. Describe how screening programs use quality and patient monitoring to improve outcomes in breast cancer screening
3. Explain the current challenges in screening and the future of organized breast cancer screening in Canada

Is It Really a Small Cyst?

Wendie A. Berg, MD, PhD, FACR, FSBI

10:15 – 10:45

Des Plaines A

PRESENTATION SUMMARY: This session will review ultrasound findings and distinctions of simple and complicated cysts, clustered microcysts, complex cystic masses and their management.

LEARNING OBJECTIVES

At the end of the presentation, participants will be able to:

1. Distinguish benign from suspicious cystic masses



2. Discuss technical tricks and clinical factors that influence assessment of cystic masses

Contrast-Enhanced Mammography

Anat Kornecki, MD

10:45 – 11:15

Des Plaines A

PRESENTATION SUMMARY: This lecture will provide an introduction to contrast enhanced spectral mammography (CESM) and its suggested clinical use.

LEARNING OBJECTIVES: At the end of the presentation, participants will be able to:

1. Describe the requirements to implement a contrast mammography program benign from suspicious cystic masses
2. Discuss the advantages and limitations of this technique.

Paradigms of Breast Imaging in Canada from the Inauguration of CSBI to now

Jean Seely, MDCM, FRCPC

11:15 – 11:45

Des Plaines A

PRESENTATION SUMMARY: This 30-minute session will include a presentation on current challenges facing breast imaging in Canada, including the 2018 Canadian Task Force Guidelines on Preventive Health Care and the impact of breast tissue density as a biomarker in breast imaging. It will review some of the successes of the CSBI since its inauguration since October 2017.

LEARNING OBJECTIVES

At the end of this session, the participant will be able to:

1. Review the 2018 Canadian Task Force on Preventive Health Care Guidelines and concerns about their negative impact on patient mortality.
2. Identify biomarkers in breast imaging that are being used to predict outcome from breast cancer
3. Identify successes of the CSBI in Canada since its inauguration in 2017.



INTERACTIVE WORKSHOPS

Tomosynthesis Workshop

Moderator: Dr. Yves Loisel

13:00 – 17:00

De la Colline

PRESENTATION SUMMARY: This simulation workshop is designed to provide individual instruction in tomosynthesis interpretation while reviewing clinical tomosynthesis data sets with accompanying standard mammography. This workshop will comprise didactic lectures about the theory and principles of digital breast tomosynthesis (DBT), including an overview of the advantages and challenges of the modality, and the current research climate. The lecture will be followed by hands-on case review, interpretation and reporting at a DBT workstation.

LEARNING OBJECTIVES

At the end of the workshop, participants will be able to:

1. Identify the advantages of digital breast tomosynthesis compared with other breast imaging modalities
2. Read and interpret digital breast tomosynthesis images
3. Differentiate and define screening principles
4. Use a tomosynthesis workstation to interpret images
5. Compare the findings of a 2D synthetic image with those of a DBT image

TARGET AUDIENCE: This workshop is designed for practicing radiologists with experience in day to day breast radiology. **Prior experience in breast tomosynthesis is not a pre-requisite.**

Breast Ultrasound Workshop

Moderator: Supriya Kulkarni

13:30 – 15:00

Abraham-Martin

LEARNING OBJECTIVES:

At the end of this workshop, participants will be able to:

1. Review and discuss the emerging ultrasound technologies and their important role in breast cancer detection and diagnosis
2. Identify the importance of breast density and the current recommendations concerning breast density
3. Discuss the pathological basis for various sonographic findings seen in daily practice
4. Recognize and distinguish findings of benign and malignant lesions along with appropriate use of the BIRADS lexicon



5. Review and discuss current techniques in ultrasound-guided breast biopsy and interventional procedures

TARGET AUDIENCE: This workshop is designed health prationners from other disciplines (family medicine, medical radiation, technologists and phycisists).

DENSE BREAST PLENARY PANEL

Moderator: Jean Seely

Panelists: Shiela Appavoo, Sharlene Bilmer, Catherine Colin, Paula Gordon, Colin Mar

15:30 – 16:30

Des Plaines A

PRESENTATION SUMMARY: This panel session will focus on the practicalities of screening for breast cancer in dense breast tissue. Presentations will include the perspective of delayed diagnosis and interval breast cancers; examples of implementing supplemental screening for women with dense breast tissue using automated whole breast ultrasound and hand held screening ultrasound from a technologist's perspective, and implementing a population-based breast density notification. The panel will provide an interactive session to address the obstacles and limitations of supplemental breast screening of dense breast tissue.

LEARNING OBJECTIVES

At the end of this session, the participant will be able to:

1. To demonstrate how supplemental breast ultrasound can be implemented in a clinical practice
2. To identify the limitations of dense breast tissue notification
3. To illustrate the challenges of performing hand held ultrasound screening.

SPEAKER & PANELIST BIOS

SHIELA APPAVOO

Medical Imaging

Shiela Appavoo is a general radiologist with an interest in Breast Imaging. She works in a large community clinic and hospital practice in Edmonton. Shiela has been involved with CAR for over 10 years through the Mammography Accreditation Program and has chaired the guidelines working group since 2010. She is a founding member and VP of CSBI.

WENDIE A. BERG, MD, PhD, FACR, FSBI

Department of Radiology, Magee-Womens Hospital of UPMC, University of Pittsburgh School of Medicine

Dr. Berg Professor of Radiology at University of Pittsburgh School of Medicine, was PI of ACRIN 6666, Screening Breast Ultrasound and MRI in High-Risk Women, and is currently conducting a large study of screening ultrasound after tomosynthesis. She is Chief Scientific Advisor to DenseBreast-info.org.



SHARLENE BILMER, MRT(R), CBI, RDMS (BR), DMS

Sharlene Bilmer has worked at the Breast Health Center for the past 17 years, specializing in all forms of Breast Imaging. She graduated 22 years ago from the Eastern Ontario School of X-ray Technology and has been employed in a variety of environments from clinic settings to a military hospital, finally settling at the Ottawa Hospital. Her passion has always been breast imaging and education. Sharlene has organized and spoken at multiple conferences on Quality Imaging, Breast Imaging and Breast Ultrasound. Sharlene has also have been employed at Algonquin College as a part-time instructor for the past 6 years, teaching Patient Management, Health Ethics, and Breast ultrasound.

CATHERINE COLIN, MD, PhD

Hospices Civils de Lyon, Breast Imaging Department, Lyon 1 University

Dre Colin is a Member of the Scientific Committee of the European Society of Breast Imaging (EUSOBI), the European breast imaging representative (EUSOBI) for Quality, Safety and Standards Committee of the European Society of Radiology, a Member of the Executive Board and of the Scientific Committee of the French Society of the Breast Imaging (SIFEM, Société Française d'Imagerie de la femme), Head of the Breast Imaging Department, Hospices Civils de Lyon, University Lyon 1, France. She is also the Radiological coordinator of the High Familial Risk Women Regional Center (France), the Consulting Expert for the French Agencies of the Ministry of Health for Breast Cancer Screening Programmes and High Risk Women Screening Guidelines.

GREGORY DOYLE, BSc, MBA

Cancer Care Program, Eastern Health, St. John's, NL

Mr. Gregory Doyle is the Division Manager, Breast Cancer Screening Program and Cervical Screening Initiatives Program at Cancer Care, a division of Eastern Health. He is also the Chair of the Canadian Breast Cancer Screening Network.

PAULA GORDON, OBC, MD, FRCPC, FSBI

University of British Columbia, Vancouver, BC

Dr. Paula Gordon is a Clinical Professor in the Department of Radiology at UBC. She is a fellow of the SBI, and on their Board of Directors. She is Medical Director of the Sadie Diamond Breast Program at BC Women's Hospital. Some of important contributions to the breast imaging literature are: her 1995 paper in Cancer, which was the first to show that ultrasound can find cancers missed on mammography in dense breasts; and her 2015 paper in AJR, showing that 98% of breast radiologists have annual mammograms starting at age 40, and recommend the same to their patients, friends and family. She also volunteers as a Director of the Board of the Canucks for Kids Fund.

She has received a Killam Teaching Prize from the University of British Columbia, a Queen Elizabeth Diamond Jubilee Medal, and was invested in the Order of British Columbia. In 2014 she was named one of Canada's 100 Most Powerful Women by the Women's Executive Network. And in 2016, she was made an honorary member of the UBC Medical Alumni.



ANAT KORNECKI, MD

Western University, London, ON

Dr. Anat Kornecki is an Associate Professor of Medical Imaging, Head of the Division of Breast Imaging at the Western University and the Regional Breast Imaging Lead at the South West Regional Cancer Program. Her main area of research is breast imaging. Dr. Kornecki had supervised several educational initiatives including the Breast Imaging Fellowship Programme and resident training. She is involved in organising CME events and workshops in Breast Imaging and presented in several forums, nationally and internationally.

SUPRIYA KULKARNI, DMRD, DNB

University of Toronto, Toronto, ON

Dr. Supriya Kulkarni is a staff radiologist at the Joint Department of Medical Imaging (JDMI) at UHN, Mount Sinai Hospital and the New Women's College Hospital, Toronto, Ontario. She is an Assistant Professor in the Department of Medical Imaging, University of Toronto. She has over 16 years of experience in the subspecialty practice in Breast Imaging at JDMI.

Dr. Kulkarni is responsible for all educational initiatives in the division of breast imaging (JDMI) including the Breast Imaging Fellowship Programme (University of Toronto) and resident training. She is involved in organising CME events & workshops in Breast Imaging and is invited as a guest speaker in several forums nationally & internationally. She is a recipient of several teaching awards including the prestigious Wightman-Berris Academy individual postgraduate teaching award (2014-2015).

She is also the recipient of the 2017 Award for Outstanding cancer education, (global) Princess Margaret Cancer Centre and is on the steering committee of the Gattuso Rapid Diagnostic Clinic at the Princess Margaret Cancer Centre. She has special interest in all aspects of Breast Imaging and particularly in Digital Breast Tomosynthesis; Breast MRI & MRI guided intervention. She is on the advisory committee of Cancer care Ontario for the Provincial High-risk Breast MRI screening (OBSP) and is the QMP facility lead, Chair of the Working Group for OBSP Screening of Transgender People and member of the Overarching Policy Steering Committee for inclusion of Trans People in Organized Cancer Screening.

YVES LOISEL, MD

Centre Hospitalier de l'Université de Québec, Québec, QC

Dr. Loisel is the owner and medical director of the Audet Clinic in Québec City. He is the Chief Radiologist at l'Hôpital du St-Sacrement, Centre Hospitalier de l'Université de Québec. Dr. Loisel is the Treasurer of the Canadian Society of Breast Imaging, an examiner with the Royal College of Physicians and Surgeons of Canada and is a tomosynthesis educator.

COLIN MAR, MD, FRCPC

BC Cancer, Vancouver, BC

Dr. Colin Mar is a radiologist at BC Cancer in Vancouver, and the medical director of the provincial BC Cancer Breast Screening program.



JEAN SEELY, MDCM, FRCPC

University of Ottawa and the Ottawa Hospital Research Institute, Ottawa, ON

Dr Jean Seely is Professor of Medicine, Department of Radiology, University of Ottawa. She is a Fellow of the Society of Breast Imaging. She is Head of the Breast Imaging Section of the Ottawa Hospital, Breast Imaging Lead for the Ontario Breast Screening Program, member of the Canadian Association of Radiologists' (CAR) Breast Imaging working group and executive member of the CAR Mammography Accreditation Program. She is on the Editorial Board of the Journal of the Society of Breast Imaging and CAR journal. She is President of the CSBI.



Canadian Society of Breast Imaging
Société canadienne de l'imagerie mammaire

